

CUBE1

Project Name:	
Type:	

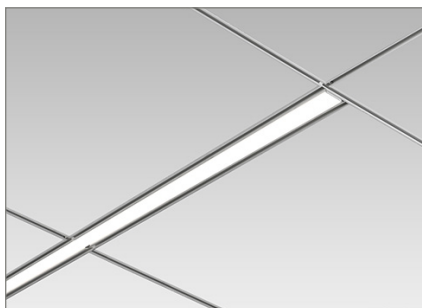

APPLICATION

The extruded aluminum CUBE1 LED Architectural Recessed Linear is perfect for multiple applications such as commercial, general office, banking, retail and educational environments.

FEATURES:

- One piece extruded aluminum housing with die-cast aluminum end caps.
- One piece extruded snap-in acrylic lens up to 8' run.
- Standard powder-coat textured white finish.

MOUNTING:

- Compatible with T-Bar and drywall ceiling.

LED:

- High quality array LEDs.
- IES LM80 tested.
- Color Temperature: 2700/3000/3500/4000/5000 (K).
- Color Rendering Index: >80 (optional>90).
- Nominal Lamp Life: 100,000 hours.
- Reported L70 hours: +60,000 (55°C).

ELECTRICAL:

- High power factor electronic driver, operate from a 120 ~ 277 Vac input range, 50 / 60 Hz.
- Features included over voltage protection, surge, short circuit protection and over load protection.
- Power Factor: typical > 0.95, THD <20, meets Class1 or Class 2 circuit.
- 0-10VDC dimming 1%~100%.
- Operating temperature: -4°F (-20°C) ~ 122°F (50°C).

- <ELCU-200>
- Guarantees emergency lighting remains ON or is turned on when power to the control device is lost.
- Interfaces with fire alarm panel or security system.
- "Watchdog" feature allows emergency loads to be controlled in tandem with normal power loads.
- UL listed for use in emergency circuits.

LISTING:

- UL / CUL listed.
- Listed to UL 1598 and UL 8750.
- UL listed for dry & damp location.
- CEC Compliant EM (please contact for more information)
- Assembled in USA (optional).
- 5 years limited warranty.
- 7 or 10 years limited warranty (optional). ¹¹

CONFIGURATIONS

Series	Size	Model #	AC Input	Lumen Output (4000K)	Lumen Efficiency (4000K)
CUBE1	2'	D9L	4.95W	544.5 lm	110 lm/W
		D18L	9.9W	1089 lm	
		D27L	14.85W	1633.5 lm	
		D36L	19.8W	2178 lm	
	3'	D9L	7.4W	814 lm	
		D18L	14.85W	1633.5 lm	
		D27L	22.2W	2442 lm	
		D36L	26.4W	2904 lm	
	4'	D9L	9.9W	1089 lm	
		D18L	19.8W	2178 lm	
		D27L	29.7W	3267 lm	
		D36L	39.6W	4356 lm	
	6'	D9L	14.85W	1633.5 lm	
		D18L	29.7W	3267 lm	
		D27L	44.55W	4900.5 lm	
		D36L	59.4W	6534 lm	
8'	D9L	19.8W	2178 lm		
	D18L	39.6W	4356 lm		
	D27L	59.4W	6534 lm		
	D36L	79.2W	8712 lm		

CCT	Multiplier		
	3000K	3500K	5000K
Down only	0.9642	0.9822	1.0357

CUBE1

ORDERING INFORMATION

EXAMPLE: CUBE1-IND-4-D18L-30K-FT-UNV-STB

MODEL	ROW ¹	SECTION ²	LED Downlight (per/4ft section)	COLOR TEMP.
CUBE1-IND (Individual Mount)	xx' Specify nominal overall row length in 1' increments (Continuous runs)	2 2' Length	D9L 9W LED (272 lm/ft)	-27K 2700K ⁴
CUBE1-CON (Continuous Row Mount)		3 3' Length	D18L 18W LED (544 lm/ft)	-30K 3000K
		4 4' Length	D27L 27W LED (816 lm/ft)	-35K 3500K
		5 5' Length	D36L 36W LED (1089 lm/ft)	-40K 4000K
		6 6' Length		-50K 5000K
		8 8' Length ³		

* Maximum wattage per 4ft section: 36W
* Contact factory for custom wattage or lumen requirement.

* Number of circuit(s) should be determined by the customer prior to ordering the continuous run considering the AC input voltage and total run wattage.

CRI	MOUNTING	VOLTAGE	EM SECTION ⁶	FINISH ¹⁴
(Blank) 80+ CRI C9 90+ CRI ⁵	G1 9/16", 15/16", 1" T-bar Ceiling Grid ¹³ FT Standard 1/2" Flange ^{14, 15} SF Spackle Flange (Trimless) ^{14, 15}	UNV 120-277V 120 120V 277 277V 347 347V ¹⁷	(Blank) None EM 1SE 1 Section 2SE 2 Section xSE x Section	(Blank) Matte White RAL #9003 (Std.) *BK Black RAL #9011 *SV Silver (RAL #9022) **CC Custom Color ¹⁸ *CSS Custom Canopy Color (White is Std.) *AMB Anti-Microbial Coating (Matte Skye White)

* Non-standard finish with extra charge.
** CC: additional charge & set up fee. Provide RAL# code.

LED DRIVER	
(Blank) 0-10V dim to 1% (Std.) (dim both uplight and downlight simultaneously) ES566 eldoLED SOLOdrive Natural Dimming to dark, 0-10V, 100% ~ 0.1% dim SD40 40% / 100% Bi-Level Step dim SDXX XX% / 100% Bi-Level Step dim (Specify XX : 10% ~ 70%) PHSR Philips Xitanium Sensor-Ready, Dali 5%~100% dim. PHDL Philips Xitanium DALI driver, Dim to 5% TDM Triac Dim. (120V only) TD30/70 30% / 70% / 100% Tri-Level Step dim TDXX/YY XX% / YY% / 100% Tri-Level Step dim (Specify XX, YY : 10% ~ 70%)	LDE1 Hi-lume 1% EcoSystem LED driver with Soft-on, Fade-to-Black dimming technology, 100% ~ 1% dim ELV ELV compatible (reverse-phase or trailing-edge), (120V only) TRIO1 Tridonic IoT ready, 1-100% dim via Smart Module Interface (SMI), automated dimming/lighting controls via Enlighted Sensor Interface DTO 0-10V DIM-TO-OFF BLT Bluetooth Mesh System (contact factory for more information)

OPTIONS	
EMG8 8W EM Battery Backup (CEC Compliant EM) ^{7, 8, 9} EMG15 15W EM Battery Backup (CEC Compliant EM) ^{7, 8, 9} EMG20 20W EM Battery Backup (CEC Compliant EM) ^{7, 8, 9} EMG25 25W EM Battery Backup (CEC Compliant EM) ^{7, 8, 9} STB Slip Through Bracket ¹² F1 Single fuse for 120/277/347V F2 Double fuse for 208/240V ELCU-200 Fail-to-on Emergency lighting, UL924 ¹⁰	AMS Bluetooth Mesh Wireless Sensor. Occupancy/Daylight/0-10V Dimming DPMS Daylight Dimming Photo Sensor (0-10 VDC Control), (additional set up / occupant remote may be required) LSR-301-S Setup Remote Control for DPMS (Required for DPMS) LSR-301-P Occupant Remote Control for DPMS O7W Optional 7 Years Limited Warranty ¹¹ O10W Optional 10 Years Limited Warranty ¹¹ ARRA Assembled in USA BAA BAA(Buy American Act) and BABA(Build America Buy America) compliant

NOTES:

- Specify only when Continuous Row Mount.
- Skip if row and section length are the same.
- Comes with 1pc 8ft lens.
- Available with C9 (CRI 90+) only.
- Lumen per watt is about 15% less than standard CRI 80+.
- EM is installed in last 4' of luminaire section. Separate section required must specify 2SE or xSE. Must specify voltage, not available with 347V.
- Contact factory for other emergency ballast options.
- Must specify voltage 120/277V, not available with 347V.
- Integrated installation may not be available with 2ft & 3ft luminaire due to limited space. Can be remote mounted.
- Shipped separately.
- This limited warranty covers electrical parts only and does not apply to labor, equipment lease, or defect from improper installation or operation.
- Required for FT and SF mounting type.
- Compatible with T-bar ceiling type.
- Compatible with hard ceiling type.
- Must be ordered with STB from the option.
- Automatic on/off is not available. Additional occupancy sensor is required or a manual on/off switch can be done.
- Not available with EM.
- Refer to color charts (RAL and/or Cardinal) in the separate attachment.

CUBE1

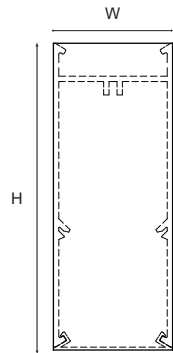

Specifications: CUBE1

Width: 1.75 (44.5)
Height: 4.5 (114.3)

* All dimensions are in inches (millimeters).

- MOUNTING DETAILS

9/16" Grid Mounting Options

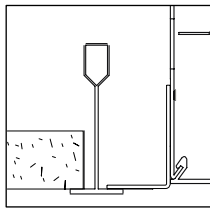

9/16" Grid, Standard Tile:
Specify G1 in part #

15/16" Grid Mounting Options

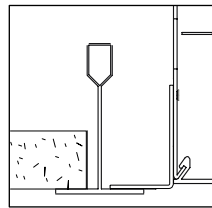

15/16" Grid, Standard Tile:
Specify G1 in part #

1" Grid Mounting Options

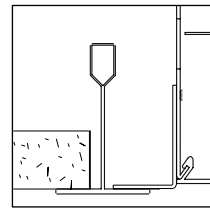

1" Grid, Standard Tile:
Specify G1 in part #

- DRYWALL RECESSED CEILING

Flanged Trim

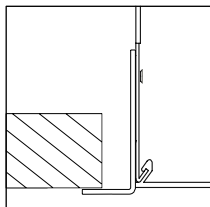

Exposed Flange Detail:
Specify FT in part #

Spackle Flanged Trim

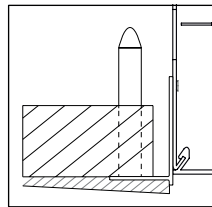

Specify SF in part #

Rotating Crossbar

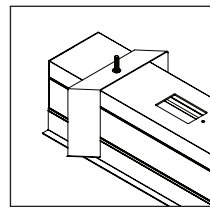

Rotating Crossbar is provided
with FT and SF type
as standard

CUBE1

COMPATIBLE DIMMER SWITCH (TABLE 1)

Model #	Brand	Compatible Dimmer Switch	
(Blank)	-	<Leviton>	IP710-LFZ
		<Lutron>	Visit www.lutron.com/advance for a list of dimmers (Mark VII) that will work with this driver.
ES566	eldoLED SOLOdrive	<Busch-Jaeger>	2112U-101
		<Jung>	240-10
		<Leviton>	IllumaTech - IP710-DLX
		<Lightolier Controls>	ZP600FAM120
		<Merten>	5729
		<Pass & Seymour>	CD4FB-W
		<Wattstopper>	DCLV1
		<Sensor Switch>	nIO EZ
		<Synergy>	ISD BC
		<ABB>	SD/S 2.16.1
		<Lutron>	Nova T: NTFTV Diva - DVTV-xx, NFTV GRAFIK Eye: GRX-TVI w GRX3503 Energy Savr Node: QSN-4T16-S TVM2 Module
<Crestron>	GLX-DIMFLV8, GLXP-DIMFLV8, GLPAC-DIMFLV4-*, GLPAC-DIMFLV8-*, GLPP-DIMFLVEX-PM, GLPP-1DIMFLV2EX-PM, GLPP-1DIMFLV3EX-PM, DIN-AO8, DIN-4DIMFLV4, CLS-EXP-DIMFLV, CLCI-1DIMFLV2EX		
LDE1	Lutron Hi-lume 1% EcoSystem	<Lutron>	PowPak Dimming Modules: RMJ-ECO32-DV-B, FCJ/FCJS-ECO ^{1,2} Energi Savr Node (120V only): QSN-1EC0-S, QSN-2ECO-S GRAFIK Eye QS/Homeworks QS control unit (120V only): QSGRJ- E(wireless) QSGR- E Quantum Hub (120V only): QP2- _2C/4C/6C/8C Homeworks QS/myRoom Plus power module (120V only): LQSE-2ECO-D
PHSR ³	Philips Xitanium Sensor-Ready	<Illumra>	<u>Single Rocker Self-Powered Light Switch (on/off, dim-up/down)</u> Illumra# ZBT-S1AWH Digi-Key# 1082-1033-ND <u>Dual Rocker Self-Powered Light Switch (on/off, dim-up/down, scene1,2)</u> Illumra# ZBT-S2AWH Digi-Key# 1082-1034-ND
TDM	KEystone	<Lutron>	Diva DV-600P, SkyLark S-600P, Ariadni AY-600P, Ariadni TG-603P, Maestro MA-600 (Digital), Diva CFL/LED DVCL-153P, Satin Colors DVSC-600P-SW
		<Leviton>	6641, IllumaTech IP106-1LX, ToggleTouch TGI06-1LW (Digital)
ELV	KEystone	<Lutron>	MAELV-600BL (Digital), DVELV-300P, SkyLark SELV-300P
DTO	Philips Xitanium Gen.2 Philips Xitanium Sensor-Ready	<Lutron>	Nova T: #NTSTV-DV http://www.lutron.com/TechnicalDocumentLibrary/NovaTB.pdf See page13.

NOTES:

- All devices connected to one FCJ/FCJS-ECO will be controlled together. Devices will dim to the same level as the result of a control command.
For more detail on adjusting low-end light level refer to Application Note#556 at www.lutron.com.
- For the Line/Hot (L/H) terminal on the driver, it is preferred not to use the switched hot (red) wire from the control but rather the hot wire directly from the power source.
- Recommended for EasySense System.